

NOTICE!!

These documents have been scanned!

Do not place un-scanned documents beneath this notice!

Do not remove this notice from this file!

GPO Jacket No. 560-102
Print Order 61540
Rise Business Services, LLC
Job=AZ15 4/29/2019



Box Number= AZ15007



Claim Begin-End: AMC445084-AMC445084

1 Initial Receipt



AZ15007-25

AMC450400-AMC453366

United States Department of the Interior
Bureau of Land Management
 DIV OF LANDS, MINRLS & ENERGY
 ONE N CENTRAL AVE
 PHOENIX, AZ 85004 -4427
 Phone: 602-417-9200

Receipt

No: 3882595

Transaction #: 3991749	
Date of Transaction: 07/07/2017	
CUSTOMER:	
BRET STALLCOP 12877 N MURPHY RD BRAZIL, IN 47834-6859 US	

ENTERED
 JUL 12 2017
 BY: *RJM*

LINE #	QTY	DESCRIPTION	REMARKS	UNIT PRICE	TOTAL
1	1.00	LOCATABLE MINERALS / MINING CLAIMS-NEW, UNADJUD, ONE OR MORE AUTH NOS / NEW MINING CLAIM PROCESSING FEE CASES: AMC445084/\$20.00		- n/a -	20.00
2	1.00	LOCATABLE MINERALS / MINING CLAIMS-NEW, UNADJUD, ONE OR MORE AUTH NOS / NEW MINING CLAIMS LOCATION FEE CASES: AMC445084/\$37.00		- n/a -	37.00
3	1.00	LOCATABLE MINERALS / MINING CLAIMS-NEW, UNADJUD, ONE OR MORE AUTH NOS / NEW MINING CLAIMS MAINTENANCE FEE CASES: AMC445084/\$155.00		- n/a -	155.00
TOTAL:					\$212.00

PAYMENT INFORMATION			
1	AMOUNT:	212.00	POSTMARKED: N/A
	TYPE:	CHECK	RECEIVED: 07/06/2017
	CHECK NO:	24363098616	
	NAME:	STALLCOP, BRET 12877 N MURPHY RD BRAZIL IN 47834-6859 US	

REMARKS

This receipt was generated by the automated BLM Collections and Billing System and is a paper representation of a portion of the official electronic record contained therein.

NOTICE!!

These documents have been scanned!

Do not place un-scanned documents beneath this notice!

Do not remove this notice from this file!

GPO Jacket No. 560-102
Print Order 61540
Rise Business Services, LLC
Job=AZ15 4/29/2019



Box Number= AZ15007



Claim Begin-End: AMC445084-AMC445084

2 Correspondence



AZ15007-25

AMC450400-AMC453366

**NO
DOCUMENTS
FOUND**

NO DOCUMENTS FOUND
NO DOCUMENTS FOUND

NOTICE!!

These documents have been scanned!

Do not place un-scanned documents beneath this notice!

Do not remove this notice from this file!

GPO Jacket No. 560-102
Print Order 61540
Rise Business Services, LLC
Job=AZ15 4/29/2019



Box Number= AZ15007



Claim Begin-End: AMC445084-AMC445084

3 Transfers



AZ15007-25

AMC450400-AMC453366

**NO
DOCUMENTS
FOUND**

NO DOCUMENTS FOUND
NO DOCUMENTS FOUND

NOTICE!!

These documents have been scanned!

Do not place un-scanned documents beneath this notice!

Do not remove this notice from this file!

GPO Jacket No. 560-102
Print Order 61540
Rise Business Services, LLC
Job=AZ15 4/29/2019



Box Number= AZ15007



Claim Begin-End: AMC445084-AMC445084

4 Annual Filings



AZ15007-25 AMC450400-AMC453366

DEPARTMENT OF THE INTERIOR
BUREAU OF LAND MANAGEMENT
MINING CLAIMS

Run Date/Time: 9/11/2018

MC Maintenance Fees Paid Through the BLM Pay Portal
(by Date Paid)

Page 676 Of 723

CBS Receipt: 4252582

Printed For Lead File # AMC445084

Agency Tracking ID: 1535765427

Assessment Year: 2019

Paid On: 9/1/2018

Number of BLM Serial Nr: 1

Total Amount Paid: \$155.00

Claim Name	BLM Serial No	Lead File No	Amount Paid
OTTER CREEK	AMC445084	AMC445084	\$155.00

United States Department of the Interior

Bureau of Land Management

BUSINESS & SUPPORT SVCS DIV

ONE N CENTRAL AVE SUITE 800

PHOENIX, AZ 85004 -4427

Phone: 602-417-9200

Receipt

No:

4252582

Transaction #: 4368099	
Date of Transaction: 08/31/2018	
CUSTOMER:	
BRET STALLCOP 12877 N. MURPHY RD. BRAZIL, IN 47834 US	

LINE #	QTY	DESCRIPTION	REMARKS	UNIT PRICE	TOTAL
1	1.00	LOCATABLE MINERALS / MINING CLAIMS-NOT NEW-UNADJUD, ONE AUTH NO. ONLY / MINING CLAIM MONEY RECEIVED CASES: AMC445084/\$155.00		- n/a -	155.00
TOTAL:					\$155.00

PAYMENT INFORMATION					
NOTE: Items will appear on credit card statement as "BLM O Mining Claim".					
1	AMOUNT:	155.00	POSTMARKED:	N/A	
	TYPE:	CREDIT CARD	RECEIVED:	08/31/2018	
	NAME:	BRET STALLCOP 12877 N. MURPHY RD. BRAZIL IN 47834 US			
	CARD NO:	XXXXXXXXXXXX5135	AUTH CODE:	03314C	
	NAME ON CARD:	BRET STALLCOP			
	SIGNATURE:				

REMARKS

This receipt was generated by the automated BLM Collections and Billing System and is a paper representation of a portion of the official electronic record contained therein.

**DEPARTMENT OF THE INTERIOR
BUREAU OF LAND MANAGEMENT
MINING CLAIMS**

MC Maintenance Fees Paid Through the BLM Pay Portal

CBS Receipt: 3965312

Printed For Lead File # AMC445084

Agency Tracking ID: 1504054655

Assessment Year: 2018

Number of BLM Serial Nr: 1

Paid On: 08/29/2017

Total Amount Paid: \$155.00

Claim Name	BLM Serial No	Lead File No	Amount Paid
OTTER CREEK	AMC445084	AMC445084	\$155.00

United States Department of the Interior
Bureau of Land Management
 BUSINESS & SUPPORT SVCS DIV
 ONE N CENTRAL AVE SUITE 800
 PHOENIX, AZ 85004 -4427
 Phone: 602-417-9200

Receipt

No: 3965312

Transaction #: 4075188	
Date of Transaction: 08/29/2017	
CUSTOMER:	
	BRET STALLCOP 12877 N. MURPHY AVE. BRAZIL, IN 47834 US

LINE #	QTY	DESCRIPTION	REMARKS	UNIT PRICE	TOTAL
1	1.00	LOCATABLE MINERALS / MINING CLAIMS- NOT NEW-UNADJUD, ONE AUTH NO. ONLY / MINING CLAIM MONEY RECEIVED CASES: AMC445084/\$155.00		- n/a -	155.00
TOTAL:					\$155.00

PAYMENT INFORMATION				
NOTE: Items will appear on credit card statement as "BLM O Mining Claim".				
1	AMOUNT:	155.00	POSTMARKED:	N/A
	TYPE:	CREDIT CARD	RECEIVED:	08/29/2017
	NAME:	BRET STALLCOP 12877 N. MURPHY AVE. BRAZIL IN 47834 US		
	CARD NO:	XXXXXXXXXXXX8033	AUTH CODE:	07521P
	NAME ON CARD:	BRET STALLCOP		
	EXPIRES:	09/2020		
	SIGNATURE:			

REMARKS

This receipt was generated by the automated BLM Collections and Billing System and is a paper representation of a portion of the official electronic record contained therein.

NOTICE!!

These documents have been scanned!

Do not place un-scanned documents beneath this notice!

Do not remove this notice from this file!

GPO Jacket No. 560-102
Print Order 61540
Rise Business Services, LLC
Job=AZ15 4/29/2019



Box Number= AZ15007



Claim Begin-End: AMC445084-AMC445084

5 Miscellaneous



AZ15007-25 AMC450400-AMC453366

**DEPARTMENT OF THE INTERIOR
BUREAU OF LAND MANAGEMENT
MINING CLAIMS**

Run Date/Time: 04/18/2018 09:47 AM

(LIVE) Serial Register Page

Page 1 of 1

01 10-21-1976;090STAT0090;43USC1744

Total Acres

Serial Number

Case Type 384201: PLACER CLAIM

20.000

AMC445084

Claim Name: OTTER CREEK

Lead File Number

Commodity :

AMC445084

Case Disposition: ACTIVE

Required Maintenance Fee: \$155.00

Name & Address

Int Rel

STALLCOP BRET

12877 N MURPHY RD

BRAZIL, IN 47834-6859

CLAIMANT

Mer Twp Rng Sec

Quadrant

District/Field Office

County

14 0090N 0050W 013

NE

HASSAYAMPA FO

YAVAPAI

Act Date

Code Action

Action Remarks

Receipt Number

06/06/2017

403 LOCATION DATE

07/06/2017

395 RECORDATION NOTICE RECD 1

3882595

08/29/2017

782 MAINTENANCE FEE PAYMENT 2018;\$155

3965312

07/06/2017

484 LOCATION YEAR / MAINTENANCE 2017;\$155

3882595

04/18/2018

669 LAND STATUS CHECKED

07/06/2017

501 ACCT ADV IN LEAD FILE AMC445084;

06/16/2017

404 COUNTY RECORDATION 2017-0030615;

Line Nr Remarks

NOTICE!!

These documents have been scanned!

Do not place un-scanned documents beneath this notice!

Do not remove this notice from this file!

GPO Jacket No. 560-102
Print Order 61540
Rise Business Services, LLC
Job=AZ15 4/29/2019



Box Number= AZ15007



Claim Begin-End: AMC445084-AMC445084

6 Location Notices-Amendments and Supporting Documents



AZ15007-25

AMC450400-AMC453366

MINING CLAIM STATUS REPORT

Data Entered: 7/12/17 Ram

MTP Checked By: 7/12/17 Ram
GEO Checked By: 7/12/17 Ram

LEAD SERIAL NUMBER: AMC 445084 thru AMC _____

NUMBER OF CLAIMS & TYPE:

____ LODGE
1 PLACER
____ ASSOCIATION PLACER
____ MILL SITE
____ TUNNEL SITE

CHARGES:

Processing Fee @ \$20 = \$ 20
Location Fee @ \$37 = \$ 37
Maintenance Fee @ \$155 = \$ 155
Add'l Maint Fee for Assoc Placer = \$ _____
SUBTOTAL \$ _____
Other Fees \$ _____
Other Fees \$ _____
TOTAL \$ 212

TOTAL ACREAGE: _____ Per Claim
(Placer Only)

NUMBER OF LOCATORS: _____

DOCUMENTS RECEIVED VIA: Over-the-Counter [] Mail **TIMELY FILED:** Yes No []

LEGAL DESCRIPTION: T 9N R 5W SEC 13
T _____ R _____ SEC _____
T _____ R _____ SEC _____
T _____ R _____ SEC _____
T _____ R _____ SEC _____

BLM [] FOREST SERVICE [] _____ SUBJ TO PL 359: Yes [] No []
WILDERNESS AREA [] _____

SPLIT ESTATE: N/A [] SX [] PX [] OTHER [] _____
SRHA [] Was proper Notice filed if located on SHRA Land? Yes [] No []

RECONVEYED MINERALS ON BLM LAND REQUIRE OPENING ORDER FROM 1944 TO 1993:
Open to Entry On _____ N/A []

COMMENTS/STATUS: VOID [] PARTIALLY VOID [] PVT MINERALS [] WITHDRAWN LANDS []
OTHER [] _____

[] Claimant acknowledges that portions of the following claim(s) site(s) may be void or voidable.

Printed Name of Claimant _____ Signature of Claimant _____

*****FINAL ADJUDICATION*****

DATE 4-18-2018 INITIALS PB

AMC445084



RETURN to:

LOCATION NOTICE FOR PLACER MINING CLAIM

Amendment BLM Serial # _____

NOTICE IS HEREBY GIVEN that the OTTER CREEK
_____ placer mining claim has been located by
BRET STALLCOP whose current mailing
address is 12877 N MURPHY RD
BRAZIL, IN 47834

BLM
Date
Stamp
2017 JUL -6 P 3:03
PHOENIX, ARIZONA

RECEIVED

The general course of this claim is WEST TO EAST and it is situated in YAVAPAI
County, Arizona. This claim is 1320 feet in length and 660 feet in width.

20 Total Claim Acreage. This claim runs from the location monument on which this location notice is
posted at the SW corner of the claim approximately 1320 feet in a EAST direction to the
EAST end line and 660 feet in a NORTH direction to the NORTH end line. This claim is
marked by four monuments, one at each corner of the claim.

The location monument on which this notice is posted is situated within Section 13, Township
9 N, Range 5 W, Gila Salt River Base and Meridian, Arizona. This claim encompasses
portions of the following legal subdivision(s) if located by legal subdivision or the following quarter section(s),
section(s), Township(s) and Range(s) THE SOUTH 1/2 OF THE SW 1/4 OF THE
NE 1/4 OF SEC 13 TWP 9N R 5W, Gila Salt River Base and Meridian, Arizona.

The locality of this claim with reference to some natural object or permanent monument and additional information
(if any) concerning its locality are as follows: LOC MARKER IS 2640 FT NORTH
AND 2640 FT EAST OF THE SW CORNER OF SEC 13

The above information is shown on the attached map.

DATED AND POSTED on the ground this 6TH day of JUNE, 2017.

LOCATOR(s) AGENT

Print Name(s) BRET STALLCOP

Signature(s) [Signature]

Form MCF102
Revised July 2014

AMC445084

MINING CLAIM MAP

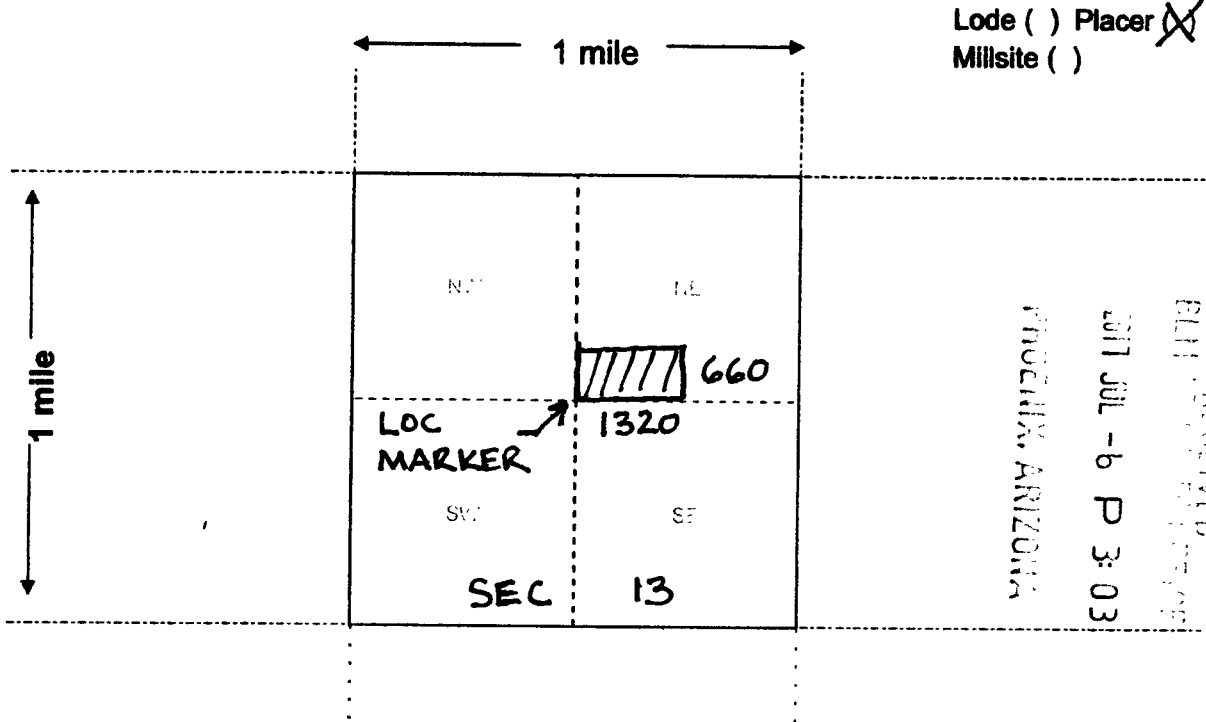

Scale: 1" = 2000 feet



1. The above map depicts the OTTER CREEK mining claim, which is located in Section (s) 13, Township 9 N, Range 5 W, Gila and Salt River Base and Meridian, YAVAPAI County, Arizona. Total claim acreage is 20 ACRES

2. The type of corner and location monuments used are as follows: 2" PVC 4' LONG

3. The bearings and distances in degrees and feet between claim corners and to a public land survey monument are as depicted on the map.

4. If the claim is a placer or millsite claim with exterior limits conforming to legal subdivisions of the public survey, provide a legal description of the claim S 1/2 OF SW 1/4 OF NE 1/4 OF SEC 13
TWP 9N RANGE 5W GSRB AND MERIDIAN

Form MCF100a
Revised July 2014

This form is available from the Arizona Geology Survey and may be reproduced.

AMC445084

Input Parameters for Geographic Report with Land

System Id = CR

Admin State = AZ

Geo State =

Casetype Begins With

Case Disp Txt = AUTHORIZED, CANCELLED, EXPIRED, PENDING, REJECTED, RELINQUISHED, WITHDRAWN

Mer Twp Rng =

Section =

Mtrs = 14 0090N 0050W 013, 14 0090N 0050W 999

Commodity =

Commodity Txt =

Pending Org =

Pend Org Decode =

Total Rows Returned: 8

RUN TIME: 01:54 PM

UNITED STATES DEPARTMENT OF INTERIOR
BUREAU OF LAND MANAGEMENT
GEOGRAPHIC REPORT WITH LAND
Sorted by Serial Number

RUN DATE: 07/12/2017
Page 2 of 2

Adm State: AZ

380910 PENDING

013 FF

E2SW;

Serial Number: AZAR 0000110

Total Case Acres: 39.400

<u>Casetype</u>	<u>Case Disp</u>	14	0090N	0050W	<u>Sect</u>	<u>Sur Typ</u>	<u>Sur Num</u>	<u>Suff</u>	<u>Subdivision</u>	<u>Act Pend</u>
285003	AUTHORIZED				013	ALIQ			E2NE,SWNE,W2SE;	

Serial Number: AZAR 0034626

Total Case Acres: 26.550

<u>Casetype</u>	<u>Case Disp</u>	14	0090N	0050W	<u>Sect</u>	<u>Sur Typ</u>	<u>Sur Num</u>	<u>Suff</u>	<u>Subdivision</u>	<u>Act Pend</u>
286202	AUTHORIZED				013	ALIQ			E2W2;	

TOWNSHIP 09 NORTH RANGE 05 WEST OF THE GILA & SALT RIVER MERIDIAN, ARIZONA

SECS	SUBDIVISION																Acres	Kind of Entry or Purpose	Serial Number or Order Number	Action Date	Remarks		
	NE 1/4				NW 1/4				SW 1/4				SE 1/4									Lots	Other Description
	NE	NW	SW	SE	NE	NW	SW	SE	NE	NW	SW	SE	NE	NW	SW	SE							
For orders affecting disposal or use of unidentified lands withdrawn for classification, minerals, water, and/or other public purposes, and Indian treaties, refer to Index to Miscellaneous Documents																							
1																		LOT 2198 (MS);	18.745	PATENT / ME	45456	5/2/1907	MC 245; 9N 4W;
																		ALL SECS 2, 16, 32, 36;		STATE GRANT	ACT OF CONGRESS	6/20/1910	TITLE TO STATE TO FIX ON APPROVAL OF SURVEY; SUBJECT TO PRIOR RIGHTS;
15	X	X	X	X									X	X	X	X							
22	X	X	X	X	X	X	X	X											640.00	SRHE	PHX-055084	1/2/1924	REL 8/5/1924;
15	X	X	X	X									X	X	X	X							
22	X	X	X	X	X	X	X	X											640.00	SRHE	PHX-057057	8/5/1924	REL 10/22/1931;
10											X	X							80.00	PATENT / CE	951020	1/6/1925	
11																		ALL;	640.00	PATENT / SRHE	952658	1/31/1925	
10	X	X	X	X									X	X	X	X			320.00				
14																		ALL;	640.00	L	82	2/28/1925	12S 25E;
																		ALL SECS 2, 16, 32, 36;		STATE GRANT	ACT OF CONGRESS	1/25/1927	EXTENDS ACT OF 6/20/1910 TO MINERAL LANDS; SUBJECT TO PRIOR RIGHTS;
15					X	X	X	X	X	X	X	X							320.00	PATENT / SRHE	1039299	8/1/1930	10N 3W;
3																		ALL;	639.88	SRHE	PHX-070833	4/14/1932	REL 11/1/1934;
5																		ALL;	640.00	SRHE	PHX-071318	9/28/1932	REL 11/10/1936;
9																		ALL;	640.00				
10					X	X	X	X	X	X									240.00				
12		X	X		X	X	X	X	X	X	X	X			X				440.00				
24																		ALL;	640.00				
26																		ALL;	640.00				
27																		ALL;	640.00				
28																		ALL;	640.00				
23	X	X	X	X									X	X	X	X			320.00				
25																		ALL; 27N 4W;	640.00	L	115	1/19/1933	QCD'S TO US: 6/13/1938;
29									X	X	X	X											
30					X	X	X	X	X	X	X	X	X	X	X	X			641.04	SRHE	PHX-072264	4/3/1933	REL 6/28/1938;
13					X	X	X	X	X	X	X	X	X	X	X	X		19S 23E;	480.00	L	119	5/12/1934	QCD'S TO US: 6/13/1938;
22									X	X	X	X	X	X	X	X			320.00				
23					X	X	X	X	X	X	X	X							320.00	L	128	12/19/1934	13N 2W;

TOWNSHIP 09 NORTH RANGE 05 WEST OF THE GILA & SALT RIVER MERIDIAN, ARIZONA

SECs	SUBDIVISION																Acres	Kind of Entry or Purpose	Serial Number or Order Number	Action Date	Remarks		
	NE 1/4				NW 1/4				SW 1/4				SE 1/4									Lots	Other Description
	NE	NW	SW	SE	NE	NW	SW	SE	NE	NW	SW	SE	NE	NW	SW	SE							
For orders affecting disposal or use of unidentified lands withdrawn for classification, minerals, water, and/or other public purposes, and Indian treaties, refer to Index to Miscellaneous Documents																							
29	X	X	X	X	X	X	X	X					X	X	X	X			480.00	L	138	5/29/1935	11S 26E;
21																		ALL;	640.00	L	141	6/26/1935	OTHER TPS: 2S 13E, 5S 12E, 5S 30E, 8S 10E, 8S 12E, 9S 31E, 11S 10E, 12S 32E, 15S 16E, 21S 12E, 24S 29E, 2N 5E, 3N 2W, 3N 4W, 3N 22W, 4N 1W, 4N 2W, 4N 3W, 4N 4W, 4N 5W, 4N 6W, 4N 7W, 4N 8W, 4N 11W, 40N 3W, 41N 3W, 6S 6W, 8S 12W, 11S 19W, 18S 3W, 19S 3W, 19S 2W, 17N 2E, 27N 11W, 27N 22W, 3N 21W, 10N 19W, 12N 18W;
15	X	X	X	X									X	X	X	X							
22	X	X	X	X	X	X	X	X											640.00	PATENT / SRHE	1078015	8/30/1935	
1			X	X			X	X	X	X	X	X	X	X	X	X	1-4		639.35	PATENT / SRHE	1079416	10/25/1935	
12																						X	
13	X		X	X																			
35		X	X						X	X		X						ALL LANDS WITHIN 25 FT OF CENTERLINE OF TRANSMISSION LINE;		O WDL PWR PROJECT	AR-774	12/31/1935	10N 4W; TERM 1/1/1951; CANC 3/17/1967;
12		X	X		X	X	X	X	X	X	X	X	X	X	X	X							
13			X	X	X	X	X	X	X	X	X	X	X	X	X	X							
24																		ALL;					
25																		ALL;					
26													X	X	X	X				QCD TO US	PHX-071832	6/13/1938	
13			X	X									X	X	X								
24		X			X				X	X	X	X											
25					X																		
26													X	X	X			ALL LANDS WITHIN 25 FT OF CENTERLINE OF TRANSMISSION LINE;		O WDL PWR PROJECT	AR-774	11/30/1938	11N 4W; TERM 1/1/1951; CANC 3/17/1967;
4													X	X	X	X			200.00	L	204	7/29/1940	7S 13E;
4			X	X			X	X	X	X	X	X					1-4		439.88	L	212	1/17/1941	16N 20E;
5																		ALL;	640.00				
8																		ALL;	640.00				
17																		ALL;	640.00				
20																		ALL;	640.00	PATENT / SX	1110886	4/3/1941	OTHER TPS: 8N 5W, 14N 2W;
3																		ALL;	639.80	PATENT / SX	1112598	11/28/1941	9N 1W;
1						X	X										3, 4		160.12	PATENT / ME	1127938	11/28/1949	10N 5W;

TOWNSHIP 09 NORTH RANGE 05 WEST OF THE GILA & SALT RIVER MERIDIAN, ARIZONA

SECS	SUBDIVISION																Acres	Kind of Entry or Purpose	Serial Number or Order Number	Action Date	Remarks			
	NE 1/4				NW 1/4				SW 1/4				SE 1/4									Lots	Other Description	
	NE	NW	SW	SE	NE	NW	SW	SE	NE	NW	SW	SE	NE	NW	SW	SE								
	For orders affecting disposal or use of unidentified lands withdrawn for classification, minerals, water, and/or other public purposes, and Indian treaties, refer to Index to Miscellaneous Documents																							
1																								
12																								
13																								
24																								
25																								
26																								
35																		M&B; SUBDIV UNDEF;	R/W TRANSMISSION LINE	AR-0110	1/1/1951	13N 2W; PROOF OF CONSTRUCTION ACCEPTED; APPVD FOR PD ONLY; APPVD 5/7/1951; TO TERM 12/31/2001; RENEWED 10/7/2003; TO TERM 5/6/2031; THIS TP REL; AMENDED 8/1/2009;		
12																		SWSWNE, S2S2NW;	R/W TELEPHONE AND TELEGRAPH LINE	AR-027662	8/26/1960	PREPERMIT; APPVD 9/16/1960; TO TERM 9/16/2010; REL 9/30/2016; CASE CLOSED 9/30/2016;		
33																	NWSE OF 2	S2S2NE, N2NENESE, NWNESE;	FLUP #192	AR-031276	3/5/1962	EXPIRED 4/1/1967;		
12					X			X	X			X												
13					X			X	X			X												
24					X			X	X			X												
25					X			X	X			X												
12																								
13																		ALL;						
24																		ALL;						
25																		ALL;						
26																		ALL;						
35																		ALL;	O CANC WDL PWR PROJECT AR-774, O 11/30/1938	A-795	3/17/1967	FPC; 13N 2W;		
33																	4	8N 5W;	R/W HAUL ROAD	A-9560	3/8/1979	EXPIRED 9/7/1988; CASE CLOSED 3/7/1989;		
6			X	X				X	X			X	X	X	X	X	1-7							
8																		ALL;						
15																		ALL;						
18	X	X	X	X	X			X	X			X	X	X	X	X	1-4							
30	X	X	X	X	X			X	X			X	X	X	X	X	1-4			3203.04	LEASE / OG	A-14957	5/27/1981	EFF 6/1/1981; TERM 6/1/1985; OG SIM OCT 1985; CASE CLOSED 1/1/1986;
12																		ALL;						

TOWNSHIP 09 NORTH RANGE 05 WEST OF THE GILA & SALT RIVER MERIDIAN, ARIZONA

SECS	SUBDIVISION																Acres	Kind of Entry or Purpose	Serial Number or Order Number	Action Date	Remarks		
	NE 1/4				NW 1/4				SW 1/4				SE 1/4									Lots	Other Description
	NE	NW	SW	SE	NE	NW	SW	SE	NE	NW	SW	SE	NE	NW	SW	SE							
For orders affecting disposal or use of unidentified lands withdrawn for classification, minerals, water, and/or other public purposes, and Indian treaties, refer to Index to Miscellaneous Documents																							
13																		ALL;					
24																		ALL;					
25																		ALL;					
26													X	X	X	X		2720.00 LEASE / OG	A-15548	5/30/1981	EFF 6/1/1981; TERM 6/1/1983; OG SIM SEP 1983;		
1			X	X					X	X	X	X	X	X	X	X	1,2						
3			X	X			X	X	X	X	X	X	X	X	X	X	1-4						
5			X	X			X	X	X	X	X	X	X	X	X	X	1-4						
7	X	X	X	X	X				X	X			X	X	X	X	1-4						
11																		ALL;					
17																		3679.91 LEASE / OG	A-16629	7/27/1981	EFF 8/1/1981; TERM 8/2/1982; OG SIM NOV 1982;		
19	X	X	X	X	X				X	X			X	X	X	X	1-4						
20																		ALL;					
22	X	X	X	X	X	X	X	X															
31	X	X	X	X	X				X	X			X	X			1-7						
33	X	X	X	X	X	X	X	X	X	X			X	X			1-4						
34	X	X	X	X	X	X	X	X	X	X			X	X			1-4						
35	X	X	X	X	X	X	X	X	X	X			X	X			1-4	4171.64 LEASE / OG	A-16637	7/27/1981	EFF 8/1/1981; TERM 8/2/1982; OG SIM NOV 1982;		
30			X															40.00 RW SEWER LINE AND PONDS	A-19992	8/13/1985	TO TERM 8/12/2005; REL AND CASE CLOSED 8/16/1990;		
15																		ALL;					
26													X	X	X	X							
30	X	X	X	X	X				X	X			X	X	X	X	1-4						
31	X	X	X	X	X				X	X			X	X			1-7	LEASE / OG	A-23065	1/14/1988	EFF 2/1/1988; TERM 2/1/1989; COMP; CASE CLOSED 6/9/1989;		
22	X	X	X	X	X	X	X	X															
25																		LEASE / OG	A-23066	1/14/1988	EFF 2/1/1988; TERM 2/1/1989; COMP; CASE CLOSED 6/9/1989;		
5			X	X			X	X	X	X	X	X	X	X	X	X	1-4						
6			X	X			X	X		X	X	X	X	X	X	X	1-7						
7	X	X	X	X	X				X	X			X	X	X	X	1-4						
8																		2561.68 LEASE / OG	A-23056	4/5/1988	EFF 5/1/1988; TERM 5/1/1989; CASE CLOSED 1/26/1990;		
17																		ALL;					
18	X	X	X	X	X				X	X			X	X	X	X	1-4						

TOWNSHIP 09 NORTH RANGE 05 WEST OF THE GILA & SALT RIVER MERIDIAN, ARIZONA

SECS	SUBDIVISION																Acres	Kind of Entry or Purpose	Serial Number or Order Number	Action Date	Remarks		
	NE 1/4				NW 1/4				SW 1/4				SE 1/4									Lots	Other Description
	NE	NW	SW	SE	NE	NW	SW	SE	NE	NW	SW	SE	NE	NW	SW	SE							
For orders affecting disposal or use of unidentified lands withdrawn for classification, minerals, water, and/or other public purposes, and Indian treaties, refer to Index to Miscellaneous Documents																							
19	X	X	X	X					X	X			X	X	X	X	1-4						
20																		2562.48	LEASE / OG	A-23057	4/6/1988	EFF 5/1/1988, TERM 5/1/1989, CASE CLOSED 1/26/1990,	
6			X	X									X	X	X	X	1, 2						
7					X				X	X			X				1-4		R/W WATER FACILITY	AZA-24422	6/15/1990	TO TERM 6/14/2020; OTHER TP 10N 5W,	
1			X	X					X	X	X	X	X	X	X	X	1, 2						
11																						ALL,	
15																						ALL,	
22	X	X	X	X	X	X	X	X											NORA / CMI	AZA-19074	8/8/1991	SEGREGATES THE MINERAL INTEREST TO THE EXTENT THAT THEY WILL NOT BE OPEN TO APPROPRIATION UNDER THE MINING LAWS AND MINERAL LEASING LAWS, SEG TO TERM 8/7/1993,	
1																						ALL,	
11																						ALL,	
15																						ALL,	
22																			ALL, LD TP 9N 4W,	AZA-23506	8/8/1991	SEGREGATES THE MINERAL INTEREST TO THE EXTENT THAT THEY WILL NOT BE OPEN TO APPROPRIATION UNDER THE MINING LAWS AND MINERAL LEASING LAWS, SEG TO TERM 8/7/1993, CASE CLOSED AND OPEN TO ENTRY 2/24/1995,	
1																						ALL,	
11																						ALL,	
15																						ALL,	
22																			ALL, LD TP 5N 2E,	AZA-23506	7/29/1993	SEGREGATES THE MINERAL INTEREST TO THE EXTENT THAT THEY WILL NOT BE OPEN TO APPROPRIATION UNDER THE MINING LAWS AND MINERAL LEASING LAWS, SEG TO TERM 7/28/1995,	
1			X	X					X	X	X	X	X	X	X	X	1, 2						
11																						ALL,	
15																						ALL,	
22	X	X	X	X	X	X	X	X										2079.23	APLN / CMI	AZA-29554	6/2/1997	SEGREGATES THE LANDS FROM APPROPRIATION UNDER THE PUBLIC LAND LAWS, INCLUDING THE MINING LAWS, SEG TO TERM 6/1/1999, (AZA-19074, AZA-23506),	
31									X	X									LD TP 8N 5W,	AZA-30388	3/26/1998	TO TERM 3/25/2048, AMENDED 7/22/1998,	
31																	3, 4		LD TP 8N 5W,	AZA-30388	7/22/1998	TO TERM 3/25/2048,	
11																						ALL,	
15																						ALL,	

TOWNSHIP 09 NORTH RANGE 05 WEST OF THE GILA & SALT RIVER MERIDIAN, ARIZONA

SECS	SUBDIVISION																Acres	Kind of Entry or Purpose	Serial Number or Order Number	Action Date	Remarks		
	NE 1/4				NW 1/4				SW 1/4				SE 1/4									Lots	Other Description
	NE	NW	SW	SE	NE	NW	SW	SE	NE	NW	SW	SE	NE	NW	SW	SE							
For orders affecting disposal or use of unidentified lands withdrawn for classification, minerals, water, and/or other public purposes, and Indian treaties, refer to Index to Miscellaneous Documents																							
22	X	X	X	X	X	X	X	X											1600.00	PATENT / CMI	02-99-0013	4/21/1999	(AZA-29554);
33	X	X	X	X	X	X	X	X	X	X			X	X			1-4			COMMUNITY PIT	AZA-31470	12/19/2000	LD TP. 8N 5W;
12																X							
13	X		X	X										X	X								
24		X			X				X	X	X	X											
25						X																	
26														X		X	X						
35		X	X						X	X		X	X				3, 4			R/W TRANSMISSION LINE AMENDED	AR-0110	8/11/2009	TO TERM 5/6/2031;



This envelope is made from 100% post-consumer waste. Please recycle - again.

PRIORITY[®] ★ MAIL ★

-  DATE OF DELIVERY SPECIFIED*
-  USPS TRACKING™ INCLUDED*
-  INSURANCE INCLUDED*
-  PICKUP AVAILABLE
* Domestic only

WHEN USED INTERNATIONALLY,
A CUSTOMS DECLARATION
LABEL MAY BE REQUIRED.

Expected Delivery Day: 07/01/2017

USPS TRACKING NUMBER



9505 5117 7192 7180 0909 26

F PRIORITY[®] ★ MAIL ★



VISIT US AT USPS.COM[®]
ORDER FREE SUPPLIES ONLINE

FROM: Bret Stalcop
12877 W. Murphy
Brazil IN 47834

TO: United States Department
of Interior
Bureau of Land Management
Lands/Recreation & Planning
One N. Central Ave
Phoenix, AZ 85004-2203

Label 228, July 2013

FOR DOMESTIC AND INTERNATIONAL USE

VISIT US AT USPS.COM[®]
ORDER FREE SUPPLIES ONLINE



This packaging is the property of the U.S. Postal Service[®] and is provided solely for use in sending Priority Mail[®] shipments. Misuse may be a violation of federal law. This packaging is not for resale. EPI4F © U.S. Postal Service; July 2013; All rights reserved.

PRIORITY[®] ★ MAIL ★



FLAT RATE ENVELOPE
ONE RATE ★ ANY WEIGHT*

RECEIVED
BLM AZ STATE OFFICE
2011 JUL -6 P 3:03
PHOENIX, ARIZONA

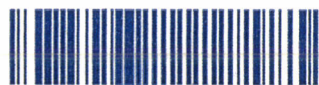

PS00001000014

EP14F July 2013
OD: 12.5 x 9.5



* Domestic only. * For International shipments, the maximum weight is 4 lbs.